

Hinge adjustments

CLIP top series

(See inside for adjustments
and installation instructions.)

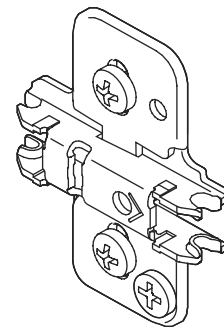
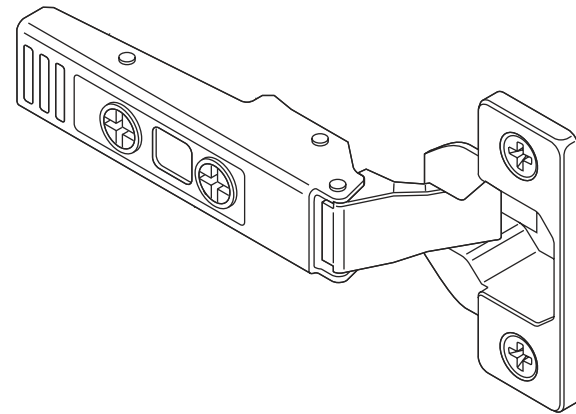

Blum, Inc.
7733 Old Plank Rd.
Stanley, NC 28164
toll free 800-438-6788
local 704-827-1345
fax 704-827-0799
internet www.blum.us

CLIP top series hinge adjustments

Side adjustment

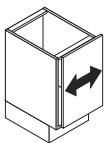

Turn front screw to increase or decrease door overlay.
Range = 3/32" (2mm)

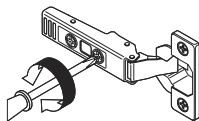

Door removal

Release the lever under the hinge arm to remove.

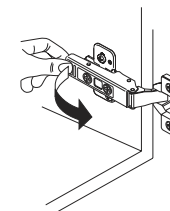

Depth adjustment

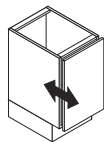

Turn rear spiral-tech cam screw to adjust door position.
Range = 3/16" (5mm)

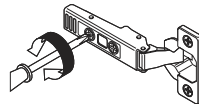

Door installation

To reinstall, place the hinge on the mounting plate and push the back with finger pressure. The "CLIP" sound confirms a secure attachment.

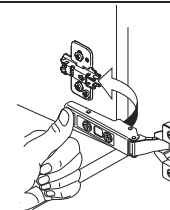

CLIP top series mounting plate adjustments

Height adjustment

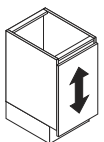

Rotate cam screw on plate to adjust door position.
Range = 5/32" (4mm)

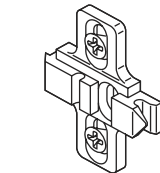
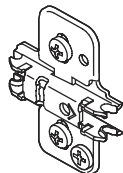
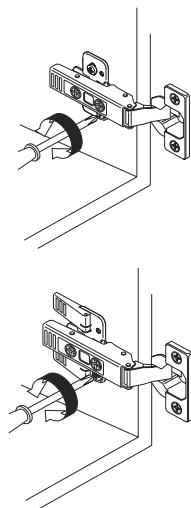

Loosen screw (s) on the mounting plate. Adjust door to position and tighten screws.
Range = 5/32" (4mm)

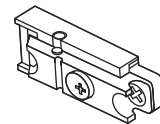
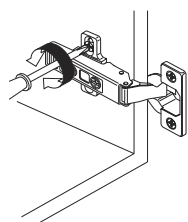

Rotate cam screw to adjust door height up or down.
Range = 5/32" (4mm)

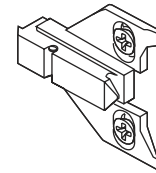
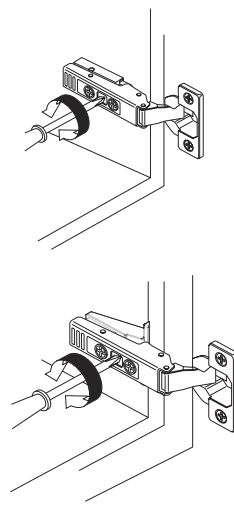

Loosen screws on mounting plate. Adjust door to position and tighten screws.
Range = 5/32" (4mm)

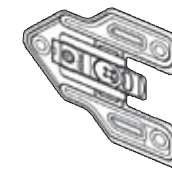
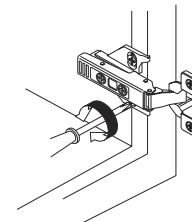

Rotate cam screw to adjust door height up or down.
Range = 5/32" (4mm)

