

GUADALUPE WALL LIGHT



DESCRIPTION

The Guadalupe is an integrated lamp and fixture that casts light from wall-mount applications in outdoor living areas. We recommend using LightingShrink connections for the Guadalupe. Dimmable with Brilliance dimmer and most magnetic transformers. ETL Certified for UL 1838 and CSA C22.2 Standards. Patent Pending.

GUADALUPE WALL LIGHT

Use	Walls, Fence Posts, Around Pools, and Other Outdoor Living Areas					
Finish	Brass, White, or Black Brass					
Includes	12 ft Lead, 2 #8 Mounting Screws for Wood or Sheet Metal, Mounting Template					
Warranty	5 Year Warranty on Guadalupe Fixtures					
Integrated Lamp	2700K, 3.8W, 200 Lumens, 90°, CRI 90, IP65, 8-15VAC, 5 year warranty, 6.03VA, 35,000 hrs					
	<table style="margin-left: 40px;"> <tr> <td>Brass</td> <td>GUADALUPE-2700-BR</td> </tr> <tr> <td>Black Brass</td> <td>GUADALUPE-2700-BR-BLK</td> </tr> <tr> <td>White</td> <td>GUADALUPE-2700-WH</td> </tr> </table>	Brass	GUADALUPE-2700-BR	Black Brass	GUADALUPE-2700-BR-BLK	White
Brass	GUADALUPE-2700-BR					
Black Brass	GUADALUPE-2700-BR-BLK					
White	GUADALUPE-2700-WH					
Integrated Lamp	3000K, 3.8W, 210 Lumens, 90°, CRI 90, IP65, 8-15VAC, 5 year warranty, 6.03VA, 35,000 hrs					
	<table style="margin-left: 40px;"> <tr> <td>Brass</td> <td>GUADALUPE-3000-BR</td> </tr> <tr> <td>Black Brass</td> <td>GUADALUPE-3000-BR-BLK</td> </tr> <tr> <td>White</td> <td>GUADALUPE-3000-WH</td> </tr> </table>	Brass	GUADALUPE-3000-BR	Black Brass	GUADALUPE-3000-BR-BLK	White
Brass	GUADALUPE-3000-BR					
Black Brass	GUADALUPE-3000-BR-BLK					
White	GUADALUPE-3000-WH					

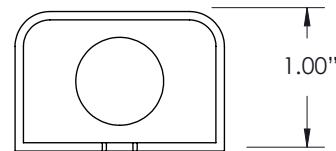

Brass (BR) White (WH) Black Brass (BR-BLK)

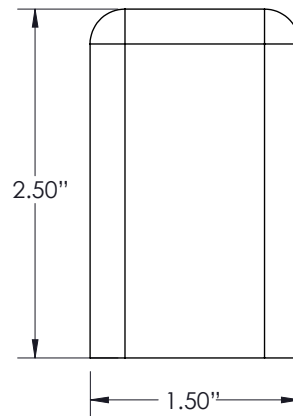



GUADALUPE-BR-BLK-3000

INSTALLING THE FIXTURE

1. Using a torpedo level and the mounting template provided, align and mark the screw and cable holes.
2. Drill the appropriate holes for the building materials to which the fixture will be mounted. Pre-drill if needed.
3. Insert and thread the top and bottom mounting screws.
4. Pass the fixture cable through the larger center hole.
5. Align the fixture with both the top and bottom screws, and slide the fixture down to hang it.
6. Tighten the bottom mounting screw until snug.
7. Connect the fixture wires to the main cable coming from the transformer.