

SCHLAGE

S-SERIES

Light/Medium Commercial and Multi-Family Housing



Application

Interior light to medium use commercial doors; office tenant spaces, laboratories; Heavy duty residential doors and multi-family housing.

Performance Features

- Handicap compliant levers.
- Heat treated steel locking components for extra strength.
- Independent heavy duty lever torsion springs for durability and long life.
- Non-handed levers (except Flair design).
- Snap-on inside rose conceals mounting screws.
- Extra-strong Everest patented keys standard for Commercial customers.

INDEX	
Cylinders	4 - 5
Designs & Finishes	2
Door Handing	8
Door Preparation	1
Functions	3
How to Order	9
Interchangeable Core	4 - 5
Latches	6
Primus® High Security Cylinders	4 - 5
Specifications	1
Strikes	7

Exploded View

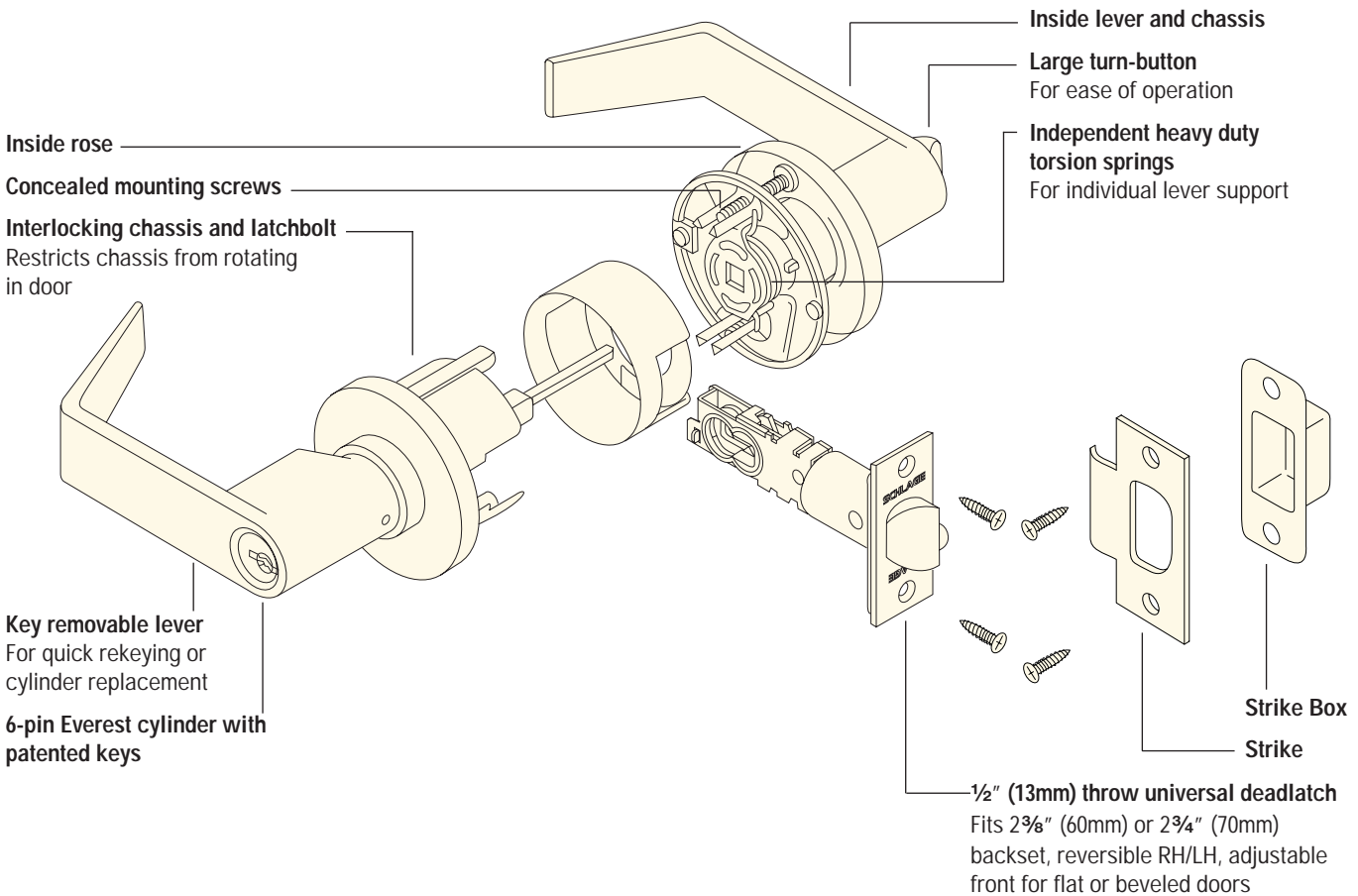

On our cover, the S-Series SATURN in Bright Brass.

Specifications

Handing:

Not handed, except Flair design.

Door Thickness:

1 $\frac{3}{8}$ " to 2" (35 mm-51 mm)

except S40D: 1 $\frac{3}{8}$ " to 1 $\frac{7}{8}$ " (35 mm-48 mm)

Backset:

Universal backset latches standard, fit either 2 $\frac{3}{8}$ " (60 mm) or 2 $\frac{3}{4}$ " (70 mm). 5" (127 mm) optional.

Fronts:

Steel. 1 $\frac{1}{8}$ " x 2 $\frac{1}{4}$ " (29 mm x 57 mm) square corner, beveled, for 2 $\frac{3}{4}$ " backset standard. For availability with specific backsets, see page 6.

Lock Chassis:

Tubular construction. Zinc with steel cover.

Latch Bolt:

Brass, chrome plated, $\frac{1}{2}$ " (13 mm) throw, deadlocking.

Exposed Trim:

Levers are zinc base, plated to match finish symbols. Roses, latch faceplates and strikes are wrought brass or bronze.

Strike:

T-strike 1 $\frac{1}{8}$ " x 2 $\frac{3}{4}$ " (29 mm x 70 mm) x 1 $\frac{1}{8}$ " (29 mm) lip to center with box standard. Optional strikes, lip lengths and ANSI strike box available. See page 7.

Cylinder & Keys:

Commercial: 6-pin patented Everest C123 keyway standard with two nickel silver keys per lock.

Residential: 6-pin C keyway, keyed 5-pin.

Keying Options:

Interchangeable core and Primus® high security cylinders. Master keying, grand master keying, and construction keying.

Warranty:

Commercial: three-year limited.

Residential: Full mechanical lifetime.

Certifications

ANSI

Meets or exceeds A156.2 Series 4000, Grade 2 strength and operational requirements.

Federal

Meets FF-H-106C.

California State Reference Code

(Formerly Title 19, California State Fire Marshal Standard)

Neptune and Saturn designs comply; levers return to within $\frac{1}{2}$ " of door face.

UL / cUL:

All locks listed for A label single doors, 4' x 8'. Letter F and UL symbol on latch front indicate listing. UL437 Listed locking cylinder optional: specify Primus 20-500 Series cylinder.

Door Preparation

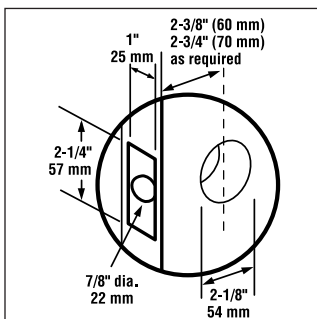

Designs & Finishes



JUPITER
 Symbol: JUP
 Material: Pressure cast zinc
 Finishes: 605, 606, 613,
 625, 626

Matches
 D-Series *ATHENS*
 and L-Series *07*
 designs

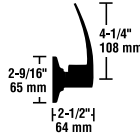

- Finishes**
- 605 Bright Brass
 - 606 Satin Brass
 - 609 Satin Brass, Blackened
 - 612 Satin Bronze
 - 613 Oil Rubbed Bronze
 - 625 Bright Chromium Plated
 - 626 Satin Chromium Plated



NEPTUNE
 Symbol: NEP
 Material: Pressure cast zinc
 Finishes: 605, 606, 609, 613,
 625, 626

Matches
 D-Series *SPARTA*
 and L-Series *17*
 designs

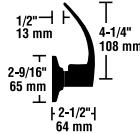

SATURN
 Symbol: SAT
 Material: Pressure cast zinc
 Finishes: 605, 606, 609,
 612, 613, 625, 626

Matches
 D-Series *RHODES*
 and L-Series *06*
 designs

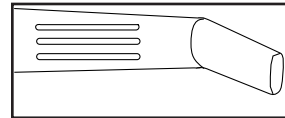
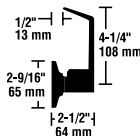



TACTILE WARNING (KNURLING)

Symbol: 8SA
 Available Saturn design only. Outside lever is knurled unless otherwise specified.

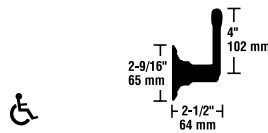

FLAIR
 Symbol: FLA
 Material: Pressure cast zinc
 Finishes: 605, 606,
 609, 612, 613, 625, 626



 Designs available with full size interchangeable core option for all keyed functions and finishes shown, except Saturn 609.

Functions

ANSI A156.2 Series 4000 Grade 2

SCHLAGE ANSI

S10D F75

Passage Latch

Both levers always unlocked.

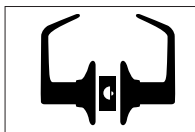

S40D F76

Bath/Bedroom Privacy Lock

Push-button locking. Can be opened from outside with small narrow tool. Turning inside lever releases button.

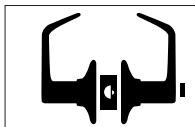

S51PD F81

Entrance Lock

Unlocked by key from outside when outer lever is locked by turn-button on inside lever. Inside lever always unlocked.

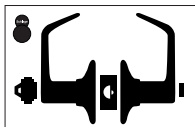

S70PD F84

Classroom Lock

Outside lever locked and unlocked by key. Inside lever always unlocked.

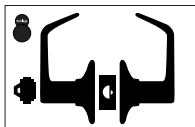

S80PD F86

Storeroom Lock

Outside lever fixed. Entrance by key only. Inside lever always unlocked.

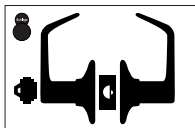

S170

Single Dummy Trim

Dummy trim for one side of door. Used for door pull or as matching inactive trim.

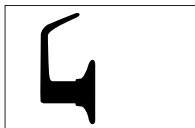

Keyed functions available with full size interchangeable core option.

Standard Cylinders

Schlage® locks are provided with cylinders precision built to extremely close tolerances and the highest standards of accuracy. Using only solid brass plugs, extruded brass shells, phosphor bronze springs, nickel silver keys and pins, ensures long life and ease of operation.

Conventional cylinders are available in Classic keyways or in the newly patented Everest® keyways. Specify keyway to differentiate between Everest and Classic. Example: C (Classic) vs. C123 (Everest).

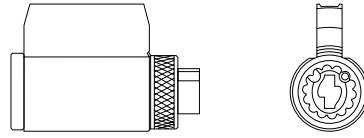

Cylinders for Keyed Levers (Bottom)

Cylinder	Description
21-028	6-Pin conventional cylinder (standard)
20-752	Primus high security cylinder
20-552	Primus UL437 Listed high security cylinder

Available 606 and 626 finish only.
Everest C123 keyway standard for Commercial; C keyway standard for Residential.
Sleeve S605-192 included.

Primus® High Security Cylinders

Primus high security cylinders are available to add patented key control and varying degrees of geographical exclusivity to most Schlage 6-pin key systems, whether Everest or Classic keyways.

In addition to a conventional pin tumbler mechanism, Primus cylinders incorporate a patented finger pin and sidebar design providing a “dual-locking” cylinder that is virtually pick-proof. Resistance to drilling and other physical attack is optional by specifying 20-500 Series UL437 Listed cylinders.

Classic Primus cylinders are recommended for upgrading existing Classic key systems. Due to its extended patent life, the newly designed Everest Primus is recommended for new key systems and for upgrading existing Everest® key systems. Specify keyway to differentiate between Everest and Classic. Example: CP (Classic) vs. C123 (Everest).

Interchangeable Core

Schlage® figure-8 interchangeable core (IC) locksets allow immediate rekeying at the door simply by using the special *control key* to replace the core in seconds.

IC locksets are available in Jupiter, Neptune and Saturn designs.



Full size interchangeable cores can be integrated into any 5 or 6-pin Schlage key system with no adverse affects on keying capacity.

To order complete locks with full size cores, change suffix from PD to RD. Example: S51RD. To order locks *less core*, change suffix to JD. To order with full size *construction core*, change suffix to TD.

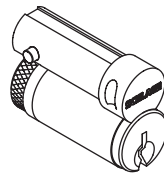

Full Size Interchangeable Cores (For JD Suffix Locksets)

Number	Description
23-030	Conventional core
20-740	Primus high security core

Available 606 and 626 finish only. Everest C123 keyway standard for Commercial; C keyway standard for Residential.

IC Conversion Kits

It is easy to convert standard S-Series locksets to accept Schlage full size interchangeable cores by changing the knob and adding the parts shown.

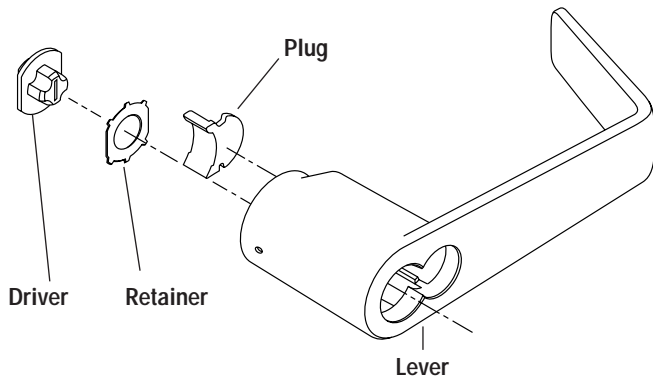

Interchangeable Core Components

Number	Description
08-030*	Lever, driver, plug, retainer
08-027*	Lever only
S605-241	Retainer
S605-242	Driver

* Specify design and finish.

IC Installation Tool

This tool is used to install the driver and retainer for full size IC in the S-Series and other Schlage locksets. Its other ends are designed to install and remove mortise cylinder housings and test mortise cylinder cam action for both small format and full size interchangeable core cylinders.

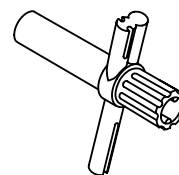

M504-413
(Order separately.)

Latches

The standard universal backset deadlatch fits both 2³/₈" (60 mm) and 2³/₄" (70 mm) backsets. They are adjustable for flat or beveled edge doors and have a 1/2" (13 mm) throw. Orders for complete locks are provided with a G506-815 sleeve for 7/8" diameter latches installed in doors with 1" (25 mm) edge bore.

All latches have 1 1/8" x 2 1/4" square corner fronts. Standard latches are shown in bold type.

Note: Failure to use the below referenced latches and fire cup, included with the lockset, will invalidate the UL Listing

Sleeve
G506-815



Used on 7/8" (22 mm) diameter latch housings in 1" (25 mm) edge bore. Furnished standard with complete locks.

Square Corner Deadlatch
16-203

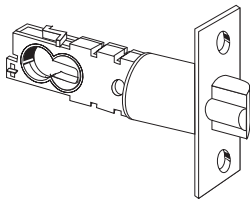

Round Corner Deadlatch
16-204

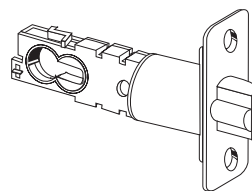

Door Reinforcement

Schlage® reinforcing units help prevent the collapse of hollow metal doors when locksets are tightly mounted.

Door Prep

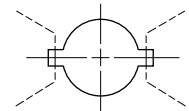

A501-566
1³/₄" (44 mm) Doors

A501-565
1¹/₈" (35 mm) Doors

Deadlatches

Backset	Faceplate Description	Number	Hsg Dia
2³/₈" or 2³/₄"	1" x 2 ¹ / ₄ " Square corner*	16-203	7/8"
	1" x 2 ¹ / ₄ ", 1/4" Radius round corner	16-204	7/8"
5"	1" x 2 ¹ / ₄ " Square corner*	16-132	7/8"

*Latches include A501-878 faceplate adapter for 1¹/₈" face.

Latch Front Adapter
A501-878

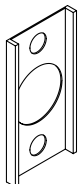

Used to adapt 1" (25 mm) wide square front faceplates to 1¹/₈" (29 mm) wide door preparations. Furnished in black plastic. Order in multiples of 100.

Strikes

All Schlage strikes are furnished complete with screws. The 10-001 standard S-Series strike has a 1 1/8" (29 mm) lip. When ordering separately, specify quantity, product number, finish, and lip length. Standard strike is shown in bold type.

T-Strike – Standard

10-001
1 1/8" x 2 3/4" x 3/32"
(29 mm x 70 mm x 2 mm)

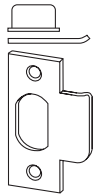

ANSI Strike

10-025
1 1/4" x 4 7/8" x 3/32"
(32 mm x 124 mm x 2 mm)

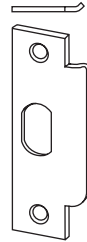

10-026

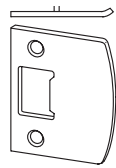

10-027

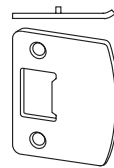

Rabbeted Latch and Strike Kit

Rabbeted latch and strike kit finishes: 605, 626.

This kit adapts square corner latches and strikes for 1/2" (13 mm) rabbeted door and frame preparations.

Rabbeted Latch and Strike Kit

39-030

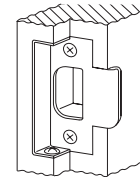
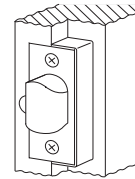

Number	Lip Length	Description
10-001	1", 1 1/8" (std), 1 1/4", 1 1/2", 1 3/4", 2" (25 mm, 29 mm, 32 mm, 38 mm, 44 mm, 51 mm)	1 1/8" x 2 3/4" (29 mm x 70 mm) Square corner, standard
10-004	1 1/8" (29 mm)	1 1/8" x 2 3/4" (29 mm x 70 mm) 1/8" (3 mm) Radius, round cnr.
10-025	1 3/16", 1 3/8" (30 mm, 35 mm)	1 1/4" x 4 7/8" (32 mm x 124 mm) ANSI
10-026	1 1/8" (29 mm)	1 5/8" x 2 1/4" (41 mm x 57 mm) Full lip, square corner
10-027	1 1/8" (29 mm)	1 5/8" x 2 1/4" (41 mm x 57 mm) Full lip, 1/4" (6 mm) radius, round corner
K510-066	—	Box, ANSI

Door Handing

Hand information is necessary for Flair design and to ensure proper finish of latchbolt and strike for split finish locks that are to be installed on reverse bevel doors. Follow the diagram to correctly determine the hand of the door.

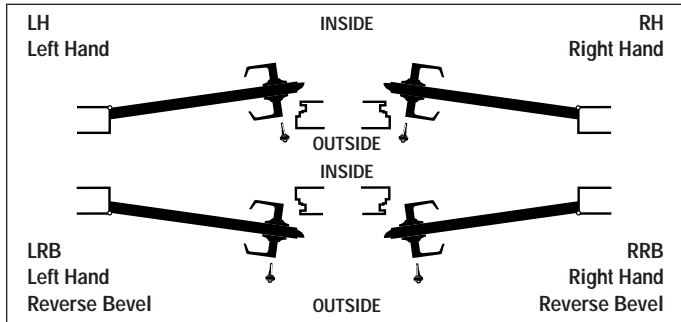

How to Order

To order Schlage products, descriptive data should be in the same sequence as shown.

Line Item	Qty	Product	Outside		Inside		Hand	Latch	Strike	DR Thk	Dim	Additional Details
			Des	Fin	Des	Fin						
1	2	3	4	5	6	7	8	9	10	11	12	13

- 1 Line item number
- 2 Quantity
- 3 Complete model number with function and cylinder type

To order cylinder options, change “PD” at the end of the model number as follows:



S51PD Standard

S51LD Less standard cylinder (For Primus cylinder, specify this option and order Primus cylinder separately.)

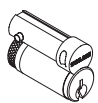

S51JD Prepared for full size interchangeable core, less core

S51RD With full size conventional interchangeable core installed. Order control keys separately.

S51TD With full size (temporary) construction core installed. Order all keys separately.

- 4 / 5 Outside design / finish.
- 6 / 7 Inside design / finish. Leave blank if same as outside.
- 8 Hand
- 9 Latch. Leave blank for standard or specify part number for optional latch. LLL=Less Latch.
- 10 Strike. Leave blank for standard or specify part number for optional strike. LLL=Less Strike.
- 11 Door thickness, if non-standard. Example: 200 = 2”.
- 12 Dimension for strike lip lengths. See strike page for availability of specific dimensions with specific strikes.
 - 100 = 1”
 - 118 = 1 1/8”
 - 114 = 1 1/4”
 - 138 = 1 3/8”
 - 112 = 1 1/2”
 - 134 = 1 3/4”
 - 200 = 2”
- 13 Keying detail (e.g. key symbol, keyway, bitting) and other special requirements.

EXAMPLE

Line Item	Qty	Product	Outside		Inside		Hand	Latch	Strike	Dr Thk	Dim	Additional Details
			Des	Fin	Des	Fin						
1	100	S51PD	SAT	605				16-132				KA4
2	100	S51LD	SAT	605				16-203				
3	100	20-724		606								1AA-100AA

Note: Schlage order forms are available at no charge by contacting your IR Security & Safety Consultant or Customer Service.

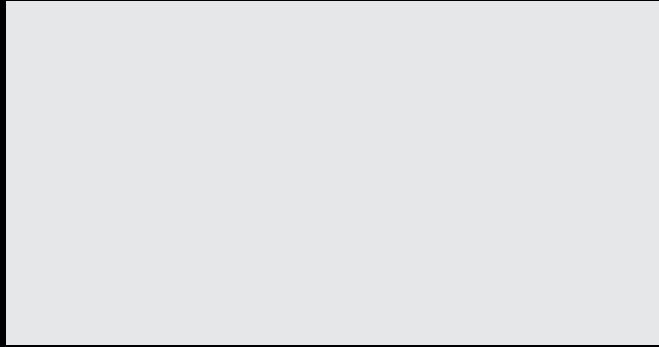

Administrative Offices

1915 Jamboree Drive, Suite 165
Colorado Springs, CO 80920
(719) 264-5300
FAX (719) 264-5382

Commercial Customer Service

1915 Jamboree Drive, Suite 165
Colorado Springs, CO 80920
(800) 847-1864
FAX (800) 452-0663
Order Entry
FAX (800) 452-0665

International Division

Ingersoll-Rand Architectural Hardware
1076 Lakeshore Road East
Mississauga, Ontario, L5E 1E4, Canada
(905) 278-6128
FAX (905) 278-1413

Internet

<http://www.schlage.com>

Fax-On-Demand

(888) 321-3228



IR Security & Safety Americas
111 Congressional Boulevard
STE 200
Carmel, IN 46032
800-847-1864
800-452-0663 Fax
www.irsecurityandsafety.com

An  **Ingersoll-Rand** business