



H-Series

Interconnected Entrance Locks



Application

Multi-family dwellings, military housing and hotel/motel.

Performance Features

Simultaneous retraction of deadbolt and latch for single-motion egress.

Patented reinforcer for deadbolt strike in wood frame to withstand kicking and prying.

Free-spinning steel-reinforced collar protects deadbolt cylinder from wrenching.

1" throw deadbolt with hardened steel roller resists sawing.

No exposed mounting screws.

Extra-strong Everest® keys standard for commercial customers.

INDEX	
Cylinders	4 - 5
Designs & Finishes	2
Door Handing	8
Door Preparation	1
Functions	3
How to Order	9
Interchangeable Core	5
Latches	6
Primus® High Security Cylinders	4 - 5
Specifications	1
Strikes	7

Exploded View

H153 function shown.

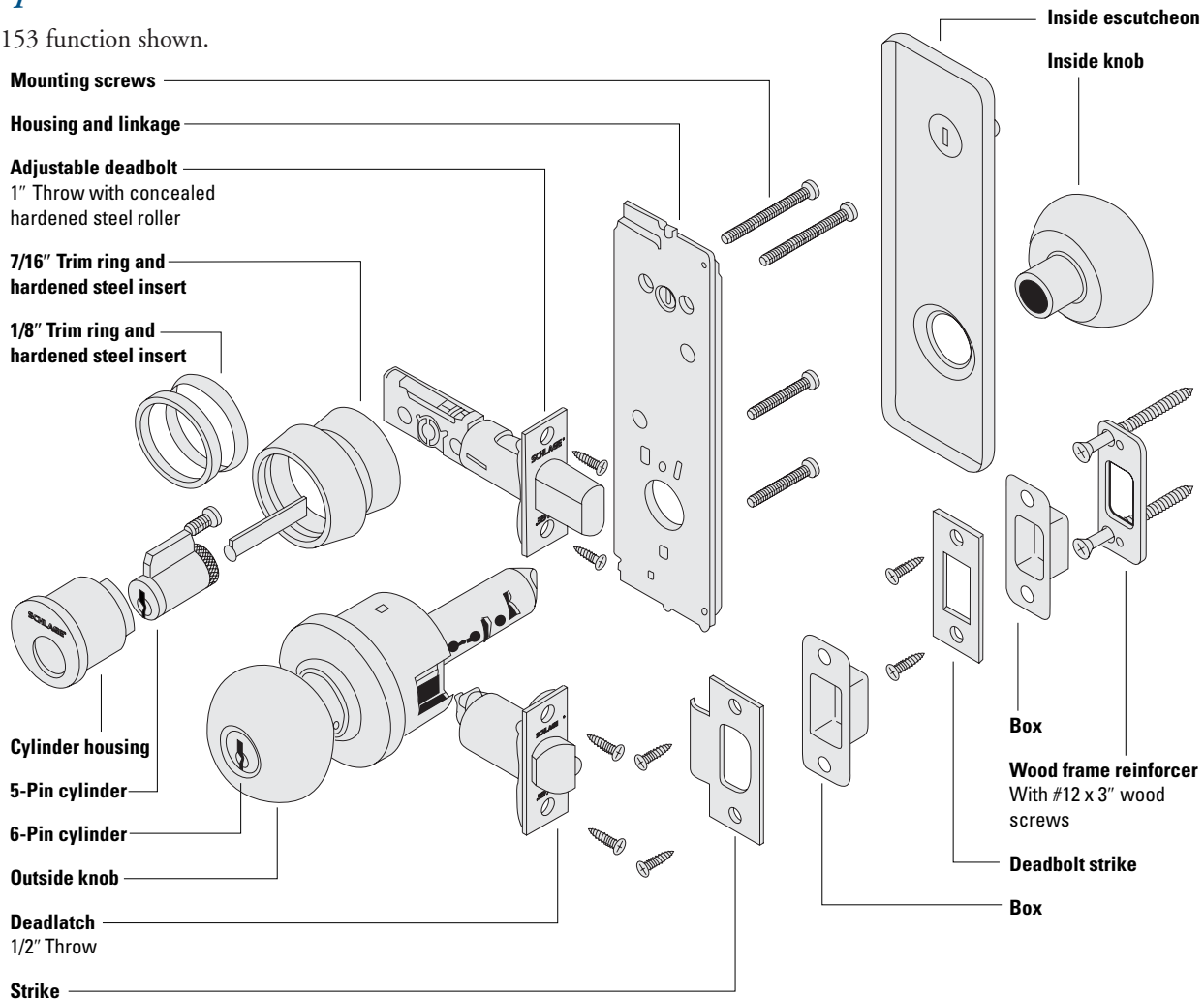

Specifications

Handing:

Field reversible.

Door Thickness:

1 3/8" to 1 3/4" (35 mm-44 mm).

Backset: 2 3/8" (60 mm) standard, 2 3/4" (70 mm) and 5" (127 mm) optional.

Fronts:

Brass or bronze. 1 1/8" x 2 1/4" (29 mm x 57 mm) square corner, beveled, for 2 3/4" (70mm) backset standard.

For availability with specific backsets, see page 6.

Lock Chassis:

Steel, zinc dichromate plated for corrosion resistance.

Deadbolt: 1" (25 mm) throw with hardened steel roller, and 1" (25 mm) housings standard.

Latch Bolt:

Brass, chrome plated, 1/2" (13 mm) throw, deadlocking.

Exposed Trim: Knobs, roses, escutcheons, latch faceplates and strikes are wrought brass or bronze. Levers are zinc base, plated to match finish symbols.

Strike:

T-strike 1 1/8" x 2 3/4" x 1 1/8" (29 mm x 70 mm x 29 mm) lip to center with box standard. Optional strikes, lip lengths and ANSI strike box available. See page 7.

Cylinder & Keys:

Commercial: 6-pin patented Everest C123 keyway standard with two nickel silver keys per lock.

Residential: 6-pin C keyway, keyed 5-pin.

Keying Options:

Interchangeable core and Primus® high security cylinders. Master keying, grand master keying, and construction keying.

Warranty:

Commercial: Three-year limited.

Residential: Full mechanical lifetime.

Door Preparation

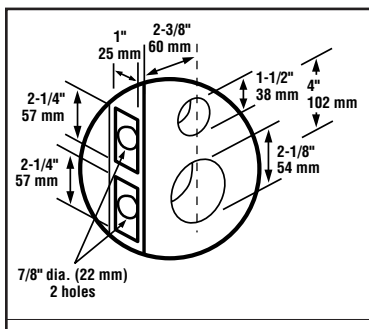

H-Series locks can be ordered for 2 1/8" top crossbore. Suffix "H" to the catalog number. Example: H110H

Certifications

Federal

Meets FF-H-106C.

UL / cUL:

All locks listed for A label single doors, 4' x 8'.

Letter F and UL symbol on latch front indicate listing.

UL437 Listed locking cylinder optional:

specify Primus 20-500 Series cylinder.



Designs & Finishes



ORBIT
 Symbol: ORB
 Material: Wrought brass
 or bronze
 Finishes: 605, 606, 609, 610,
 611, 612, 613, 616, 625, 626



626

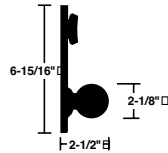

● Full size interchangeable core option available in H110, H153 and H180 functions.



LEVON
 Symbol: LEV
 Available inside only,
 on H153, H180 and H185
 functions only.
 Material: Pressure cast zinc
 Finishes: 605, 612, 613, 626

613

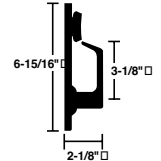

PLYMOUTH
 Symbol: PLY
 Material: Wrought brass
 or bronze
 Finishes: 605, 606, 609, 610,
 611, 612, 613, 616, 625, 626



626

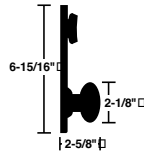

● Full size interchangeable core option available in H110 function only.



605

35-056 METEOR
Outside Escutcheon
 3 1/4" x 8 1/4" x 3/16"
 Order separately.
 Material: Wrought brass
 or bronze
 Finishes: 605, 606, 609, 612,
 613, 625, 626

Finishes

- 605 Bright Brass
- 606 Satin Brass
- 609 Antique Brass
- 610 Bright Brass, Blackened
- 611 Bright Bronze
- 612 Satin Bronze
- 613 Oil Rubbed Bronze
- 616 Antique Bronze
- 625 Bright Chromium Plated
- 626 Satin Chromium Plated

Functions

ANSI A156.12 Grade 2

SCHLAGE ANSI
H110 F95

Entrance, Single Locking

Deadbolt thrown or retracted by key in upper cylinder from outside or thumbturn inside. Latchbolt retracted by knob from either side. Turning inside knob or lever retracts deadbolt and latchbolt simultaneously for immediate exit.

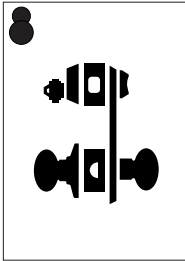

H153 F97

Entrance, Double Locking

Deadbolt thrown or retracted by key in upper cylinder from outside or thumbturn inside. Deadlatch retracted by key in outside knob when locked by pushing turn-button in inside knob or lever. Outside knob may be fixed in locked position by rotating turn-button. Turning inside knob or lever retracts deadbolt and deadlatch simultaneously for immediate exit.

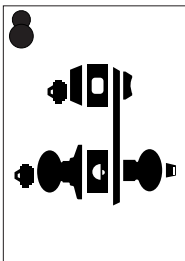

H180

Storeroom Lock

Deadbolt operated by key from outside or thumbturn inside. Bolt automatically deadlocks when fully thrown. Deadlatch retracted by key from outside. Inside knob retracts both latch and deadbolt simultaneously for immediate exit. Outside knob is always locked.

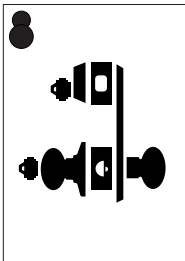

 Functions available with full size interchangeable core option with Orbit design. Only H110 is available in IC for Plymouth design.

Functions

ANSI A156.12 Grade 2

SCHLAGE ANSI
H185 F100

Hotel/Motel Lock

Deadbolt thrown or retracted by (emergency master) key in upper cylinder from outside or thumbturn inside. Deadlatch retracted by key in outside knob, except when lock is in shutout mode by pushing button in inside knob or lever, also activating visual occupancy indicator. Only emergency master key operates outside knob when in shutout mode. Turning inside knob or lever releases shutout mode and retracts deadbolt and deadlatch simultaneously for immediate exit.

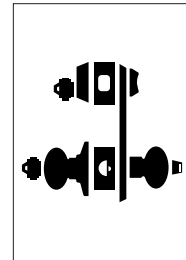

H170

Inside Half Dummy Trim

Snap-on rose and knob. Concealed mounting screws.

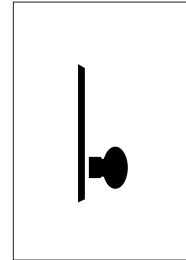

Standard Cylinders

Schlage® locks are provided with cylinders precision built to extremely close tolerances and the highest standards of accuracy. Using only solid brass plugs, extruded brass shells, phosphor bronze springs, and nickel silver keys and pins ensure long life and ease of operation.

Conventional cylinders are available in Classic keyways or in the newly patented Everest® keyways. Specify keyway to differentiate between Everest and Classic.

Example: C (Classic) vs. C123 (Everest).

Primus® High Security Cylinders

Primus high security cylinders are available to add patented key control and varying degrees of geographical exclusivity to most Schlage 6-pin key systems, whether Everest or Classic keyways.

In addition to a conventional pin tumbler mechanism, Primus cylinders incorporate a patented finger pin and sidebar design providing a “dual-locking” cylinder that is virtually pick-proof. Resistance to drilling and other physical attack is optional by specifying 20-500 Series UL437 Listed cylinders.

Classic Primus cylinders are recommended for upgrading existing Classic key systems. Due to its extended patent life, the newly designed Everest Primus is recommended for new key systems and for upgrading existing Everest® key systems. Specify keyway to differentiate between Everest and Classic.

Example: CP (Classic) vs. C123 (Everest).

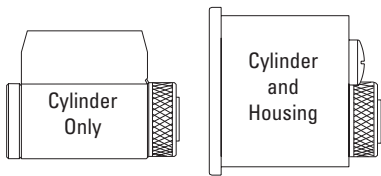

Cylinders for Deadbolt (Top)

Cylinder Only	Cyl. & Housing	Description
22-001	22-017	5-Pin conventional (Residential standard)
22-002	22-019	6-Pin conventional (Commercial standard)
20-729	20-730	Primus high security
20-529	20-530	Primus UL437 Listed high security

Cylinder only available 606 and 626 finish only.
 Cylinder with housing available 605, 606, 609, 610, 611, 612, 613, 616, 625, 626.
 Everest C123 keyway standard for Commercial; C keyway standard for Residential.

Cylinder for Most Functions

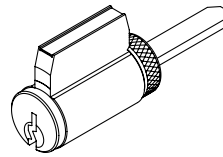

Hotel Function Indicator Cylinder

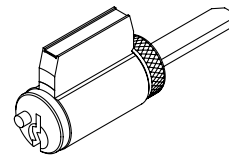

Standard Cylinders

Number		
Orbit Design	Plymouth Design	Description
21-002-122	21-002	6-Pin conventional (standard)
20-724-122	20-724	Primus high security
20-524-122	20-524	Primus UL437 Listed high security
21-003-168	21-003	Hotel Function (H185) with indicator

Available 606 and 626 finish only. Everest C123 keyway standard for Commercial; C keyway standard for residential.

Interchangeable Core



Schlage® figure-8 interchangeable core (IC) locksets allow immediate rekeying at the door simply by using the special *control key* to replace the core in seconds.

Only the Orbit knob is available with IC.

Full size interchangeable cores can be integrated into any 5 or 6-pin Schlage key with no adverse affects on keying capacity.

To order complete locks with full size cores, add suffix **R**. Example: H153**R**. To order locks *less core*, change suffix to **J**. To order with full size *construction core*, change suffix to **T**.



626

ORBIT

Symbol: ORB
 Material: Wrought brass or bronze
 Finishes: 605, 606, 609, 610, 611, 612, 613, 616, 625, 626

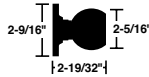

Finishes

- 605 Bright Brass
- 606 Satin Brass
- 609 Antique Brass
- 610 Bright Brass, Blackened
- 611 Bright Bronze
- 612 Satin Bronze
- 613 Oil Rubbed Bronze
- 616 Antique Bronze
- 625 Bright Chromium Plated
- 626 Satin Chromium Plated

Cores and IC Cylinders & Parts

Full Size Core

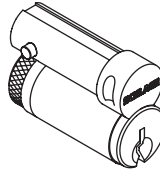

Full Size Interchangeable Cores

Number	Description
23-030	Conventional core
20-740	Primus high security core

Available 606 and 626 finish only. Everest C123 keyway standard for Commercial; C keyway standard for Residential.

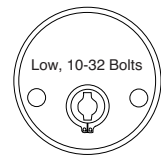
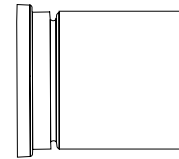
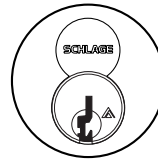

IC Cylinders for Deadbolt (Top) Tailpiece not included.

Number	Description
22-061	Housing less core
22-064	Housing with conventional core
20-784	Housing with Primus core

Available 605, 606, 609, 610, 611, 612, 613, 616, 625, 626. Everest C123 keyway standard for Commercial; C keyway standard for Residential.

Driver and Retainer for IC Knob

01-053

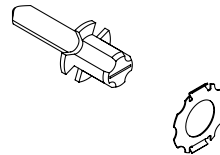

IC Installation Tool

This tool is used to install the driver and retainer for full size IC in Schlage knobs and levers. Its other ends are designed to install and remove mortise cylinder housings and test mortise cylinder cam action for both small format and full size interchangeable core cylinders.

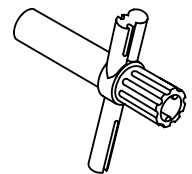

M504-413
(Order separately.)

Latches & Deadbolts

H-Series latches and deadbolts can be ordered in combinations, separately or with locks. When ordering separately, specify quantity, product number, and finish. Standard deadbolt/latchbolt combinations, per backset, are shown in bold type.

Square Corner

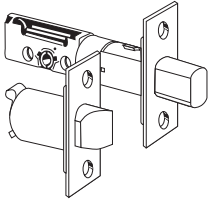

Round Corner

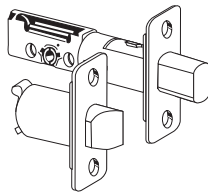

Circular Drive-in

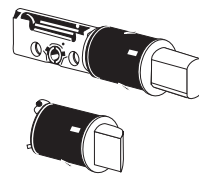

Backset	Description	Hsg Dia	Latch	Deadbolt	Specify Combo Number	Add to Lock Price
Deadbolt/Springleth Combinations for Single Locking Functions (H110)						
2 3/8"	Square corner, 1" x 2 1/4", standard	7/8"	11-068	12-237	19-055	N/C
	Square corner, 1 1/8" x 2 1/4"	1"	11-068	12-240	19-063*	
	1/4" Radius round corner, 1" x 2 1/4"	7/8"	11-069	12-238	19-067	
	Circular, drive-in, 626 only for bolt, 605 and 626 only for latch	1"	11-110	12-239	19-056	
2 3/4"	Square corner, 1" x 2 1/4"	7/8"	11-111	12-237	19-059	
	Square corner, 1 1/8" x 2 1/4"	1"	11-111	12-240	19-065*	
	1/4" Radius round corner, 1" x 2 1/4"	7/8"	11-112	12-238	19-068	
	Circular, drive-in, 626 only for bolt, 605 and 626 only for latch	1"	11-113	12-239	19-060	
5"	Square corner, 1" x 2 1/4"	7/8"	11-068	12-224	19-043**	\$14.60
Deadbolt/Deadlatch Combinations for Double Locking Functions (H153, H180, H185)						
2 3/8"	Square corner, 1" x 2 1/4", standard	7/8"	11-085	12-237	19-057	N/C
	Square corner, 1 1/8" x 2 1/4"	1"	11-085	12-240	19-064*	
	1/4" Radius round corner, 1" x 2 1/4"	7/8"	11-088	12-238	19-069	
	Circular, drive-in, 626 only for bolt, 605 and 626 only for latch	1"	11-104	12-239	19-058	
2 3/4"	Square corner, 1" x 2 1/4"	7/8"	11-091	12-237	19-061	
	Square corner, 1 1/8" x 2 1/4"	1"	11-091	12-240	19-066*	
	1/4" Radius round corner, 1" x 2 1/4"	7/8"	11-092	12-238	19-070	
	Circular, drive-in, 626 only for bolt, 605 and 626 only for latch	1"	11-105	12-239	19-062	
5"	Square corner, 1" x 2 1/4"	7/8"	11-085	12-224	19-045**	14.60

* Includes A501-878 latch front adapter and G506-815 housing sleeve for latch and bolt.

** Includes A501-878 latch front adapter and G506-815 housing sleeve for latch and bolt with 41-005 backset extension link for latch.

Latch Front Adapter

A501-878

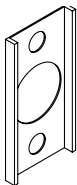

Used to convert 1" (25 mm) wide square front faceplates for 1 1/8" (29 mm) wide door preparations. Furnished in black plastic. Order in multiples of 100.

Sleeve

G506-815



Used on 7/8" (22 mm) diameter latch housings in 1" (25 mm) edge bore. Furnished standard with complete locks.

Door Reinforcement

Schlage® reinforcing units help prevent the collapse of hollow metal doors when locksets are tightly mounted.



A501-565

1 1/8" (35 mm) Doors

A501-566

1 3/4" (44 mm) Doors

Door Prep

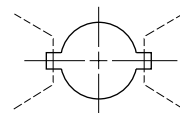

Strikes

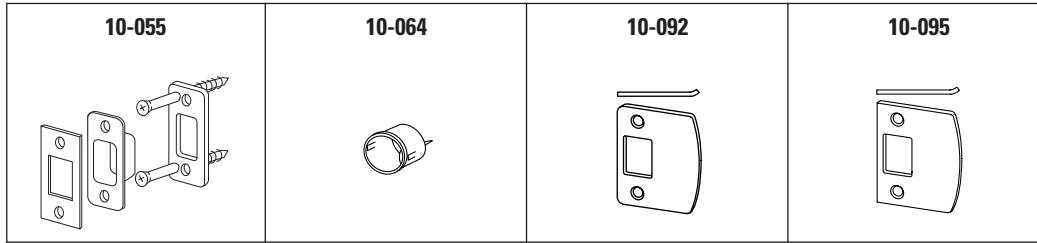

Deadbolt Strikes		
Part Number	Description	Lip Length
10-055	Square corner, box, 1 1/8" x 2 3/4", standard	—
10-064	Circular drive-in, thimble strike, 1 3/16" diameter, 494 (for 626) only	
10-092	1/4" Radius round corner, full lip, no box, 1 5/8" x 2 1/4"	1 1/8"
10-095	Square corner, full lip, no box, 1 5/8" x 2 1/4"	

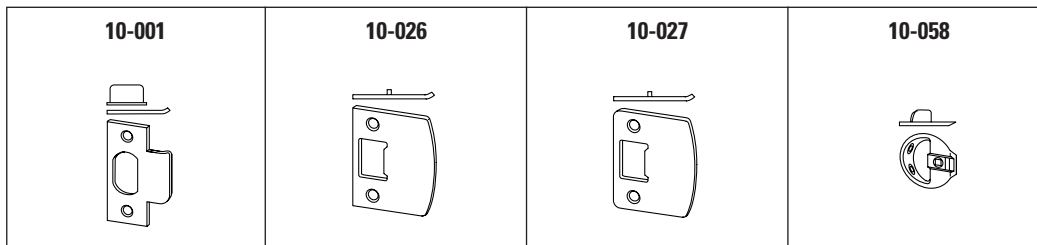

Deadlatch Strikes		
Part Number	Description	Lip Length
10-001	Square corner, T-strike, box, 1 1/8" x 2 3/4", standard	1 1/8"
10-026	Square corner, full lip, no box, 1 5/8" x 2 1/4"	
10-027	1/4" Radius round corner, full lip, no box, 1 5/8" x 2 1/4"	1 7/32"
10-058	Circular, adjustable, 1 3/4" diameter, 605 and 626 only	

Deadbolt/Deadlatch Strike Combinations		
Combo Number	Deadbolt Strike	Deadlatch Strike
10-250	10-055	10-001, 1 1/8" Lip
10-251	10-064	10-001, 1 1/8" Lip
10-252	10-055	10-026
10-253	10-064	10-026
10-255	10-055	10-027
10-256	10-064	10-027
10-257	10-092	10-027
10-258	10-064	10-058
10-259	10-095	10-026

Door Handing

H-Series locks are reversible. However, the correct hand should be specified for all lockets to assure keyways are right side up. Hand information is also necessary to ensure proper finish of latch, bolt and strike in split finish locksets and for reverse bevel doors. Follow the diagram to determine the hand of the door.

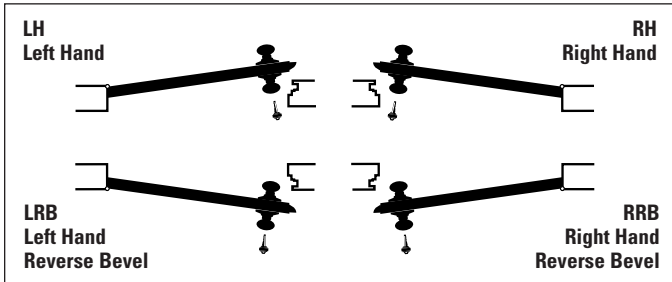

How to Order

To order Schlage products, descriptive data should be in the same sequence as shown.

Line Item	Qty	Product	Prep	Outside		Inside		Hand	Latch	Strike	Dim	Additional Details
				Des	Fin	Des	Fin					
1	2	3	4	5	6	7	8	9	10	11	12	13

- 1 Line item number
- 2 Quantity
- 3 Complete model number with function and cylinder type

To order cylinder options, add suffix to the model number as follows:



- H153 5-pin upper cylinder (standard for Residential)
- H1536 6-pin upper cylinder (standard for Commercial)
- H153L Less standard cylinder(s). For Primus cylinder, specify this option and order Primus cylinder(s) separately.

H153J Prepared for full size interchangeable core, less core. For Primus cylinder, specify this option and order Primus cylinder(s) separately.



- H153R With full size conventional interchangeable core installed. Order control keys separately.
- H153T With full size (temporary) construction core installed. Order all keys separately.
- H153J1 Knob prepared for full size IC, less core; standard cylinder for deadlock.
- H153J2 Deadlock prepared for full size IC, less core; standard cylinder for knob.
- H153R1 Full size IC installed in knob; standard cylinder for deadlock. Order control keys separately.
- H153R2 Full size IC installed in deadlock; standard cylinder for knob. Order control keys separately.

- 4 Leave blank for 1-1/2" diameter top cross-bore. Specify "H" for 2-1/8" diameter top cross-bore.
- 5/6 Outside design / finish.
- 7/8 Inside design / finish. Leave blank if same as outside.
- 9 Hand
- 10 Latch. Leave blank for standard or specify part number for optional latch. LLL=Less Latch.
- 11 Strike. Leave blank for standard or specify part number for optional strike. LLL=Less Strike.
- 12 Dimension for strike lip lengths. See strike page for availability of specific dimensions with specific strikes.
 - 100 = 1"
 - 118 = 1 1/8"
 - 114 = 1 1/4"
 - 138 = 1 3/8"
 - 112 = 1 1/2"
 - 134 = 1 3/4"
 - 200 = 2"
- 13 Keying detail (e.g. key symbol, keyway, bitting) and other special requirements.

EXAMPLE

Line Item	Qty	Product	Prep	Outside		Inside		Hand	Latch	Strike	Dim	Additional Details
				Des	Fin	Des	Fin					
1	100	H110L		ORB	605			RH				
2	100	20-724			606							1AA-100AA
3	50	H153	H	PLY	626	LEV	626	LRB				KA E00000

Note: Schlage order forms are available at no charge by contacting your IR Security & Safety Consultant or Customer Service.



Ingersoll Rand's Security Technologies Sector is a leading global provider of products and services that make environments safe, secure and productive. The Sector's market-leading products include electronic and biometric access control systems; time and attendance and personnel scheduling systems; mechanical locks and portable security, door closers and exit devices, steel doors and frames, architectural hardware and technologies and services for global security markets.

www.schlage.com www.ingersollrand.com